

OFFICE MEMBERSHIP

SOHO WORKS

WHITE CITY



About Soho Works

Soho Works is an international network of workspaces by Soho House, designed and equipped to help creative thinkers and businesses connect, collaborate, and grow.

Our spaces combine the 'home away from home' feeling of our Houses with all the tools, technology and equipment to help you do your best work.

Each workspace offers meeting rooms, flexible private hire options and a curated programme of member events to help you and your business grow.

Open now in **180 Strand, Dean Street, White City** and **Shoreditch**

Prices are available upon request.



White City



Set next to White City House, in the historical Television Centre, our 30,000 sq ft workspace has multiple meeting rooms, podcast recording equipment, phone booths, and a fully equipped kitchen, plus private office for teams of all sizes.

2 Television Centre, London, W12 7FR

To find out more about White City Soho Works, click [here](#)

White City



Soho Works office members have lockable private spaces for teams to work and collaborate, with up to 12 meeting room credits per month.

Enjoy all the benefits of a Lounge membership, plus complimentary Soho Friends membership – this gives you access to Soho House bedrooms, Studios and events, as well as benefits at our spas, restaurants and Soho Home.

2 Television Centre, London, W12 7FR

To find out more about White City Soho Works, click [here](#)



OFFICE ONE

Natural light
Overlooking Wood Crescent
Lockable storage drawers
Custom-built wooden desks
Humanscale ergonomic chairs

Seats 8
407 sq ft

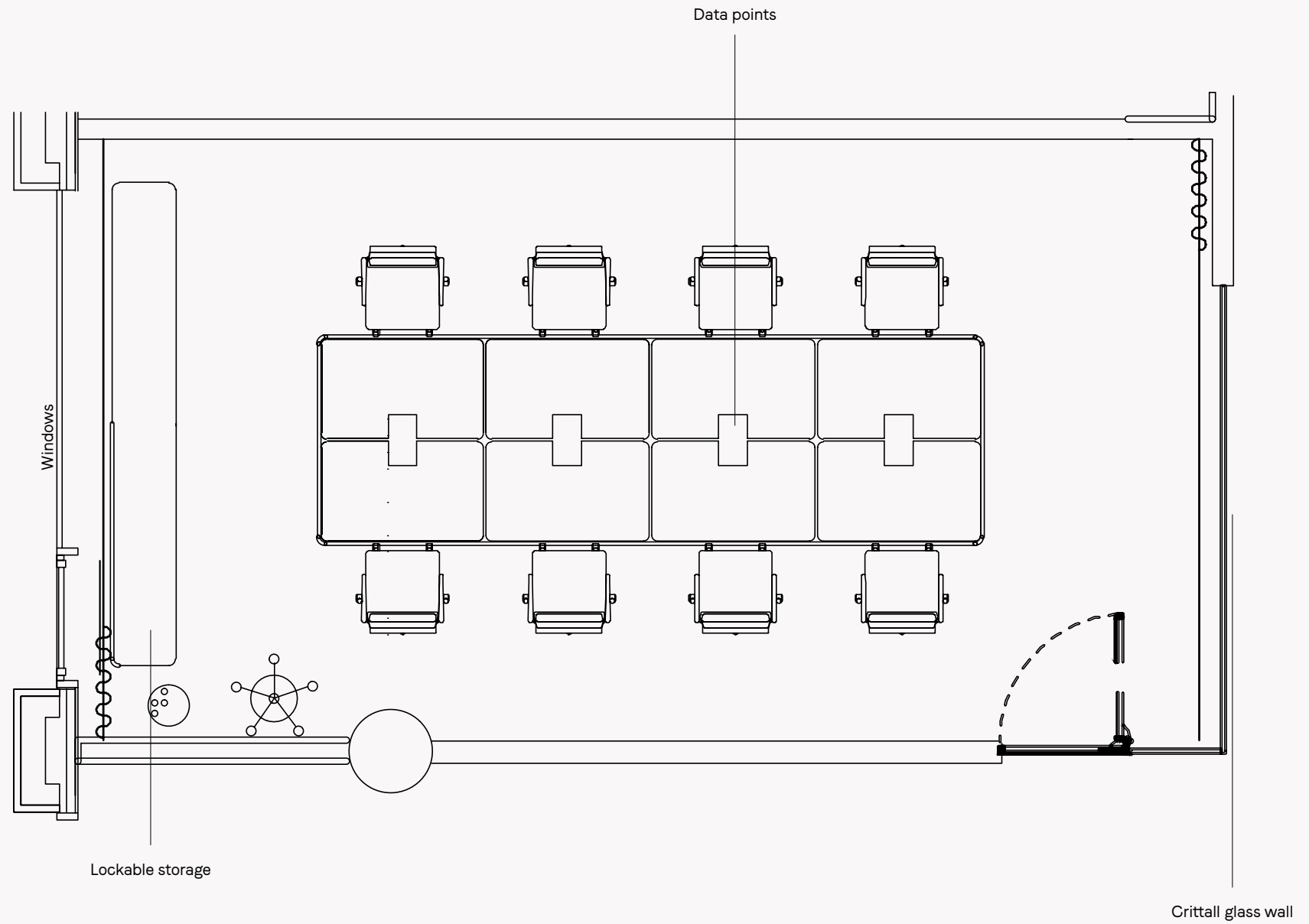

OFFICE TWO

Natural light
Overlooking Wood Crescent
Additional lounge area
Lockable storage drawers
Large screen with video capabilities
Custom-built wooden desks
Humanscale ergonomic chairs

Seats 6
407 sq ft

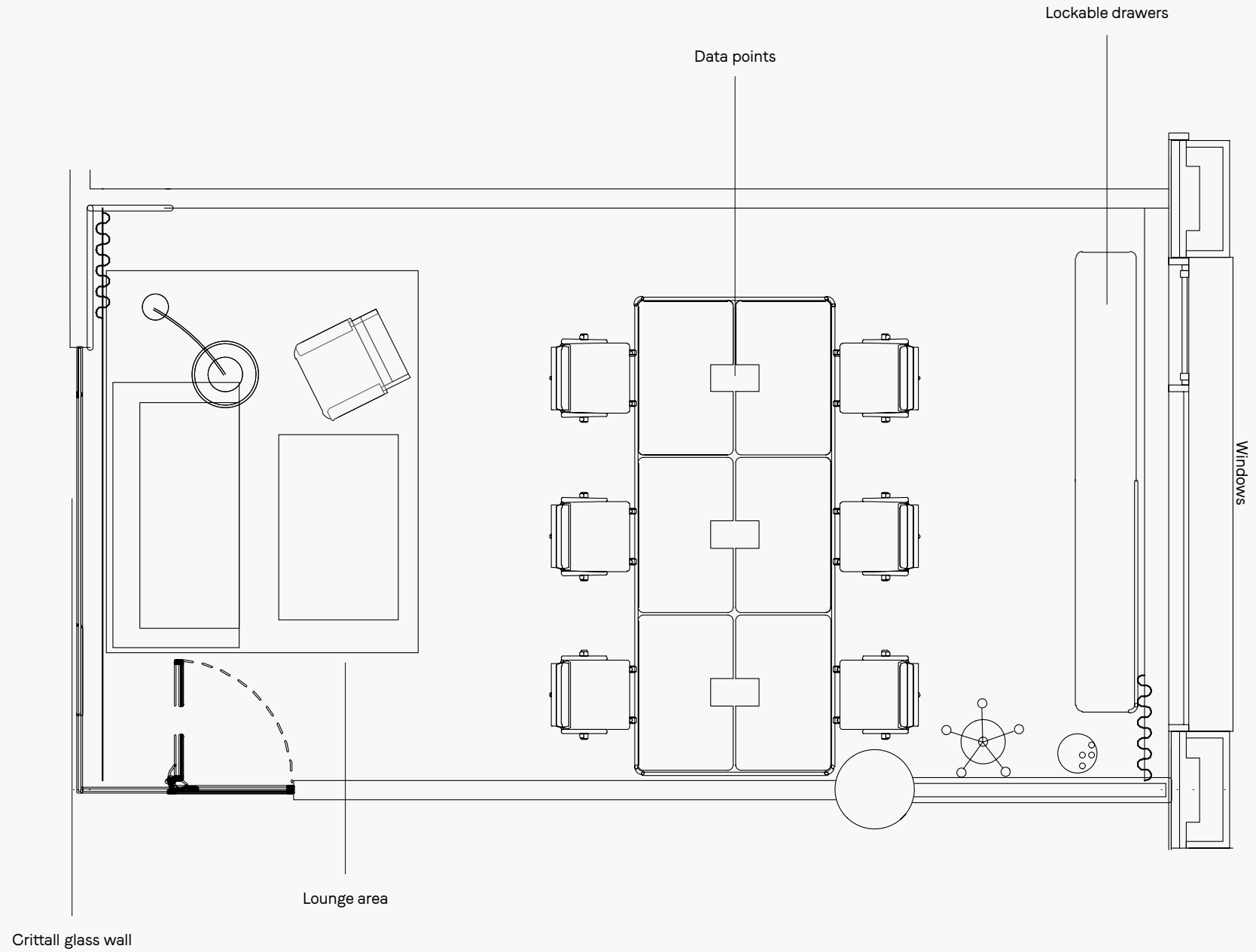

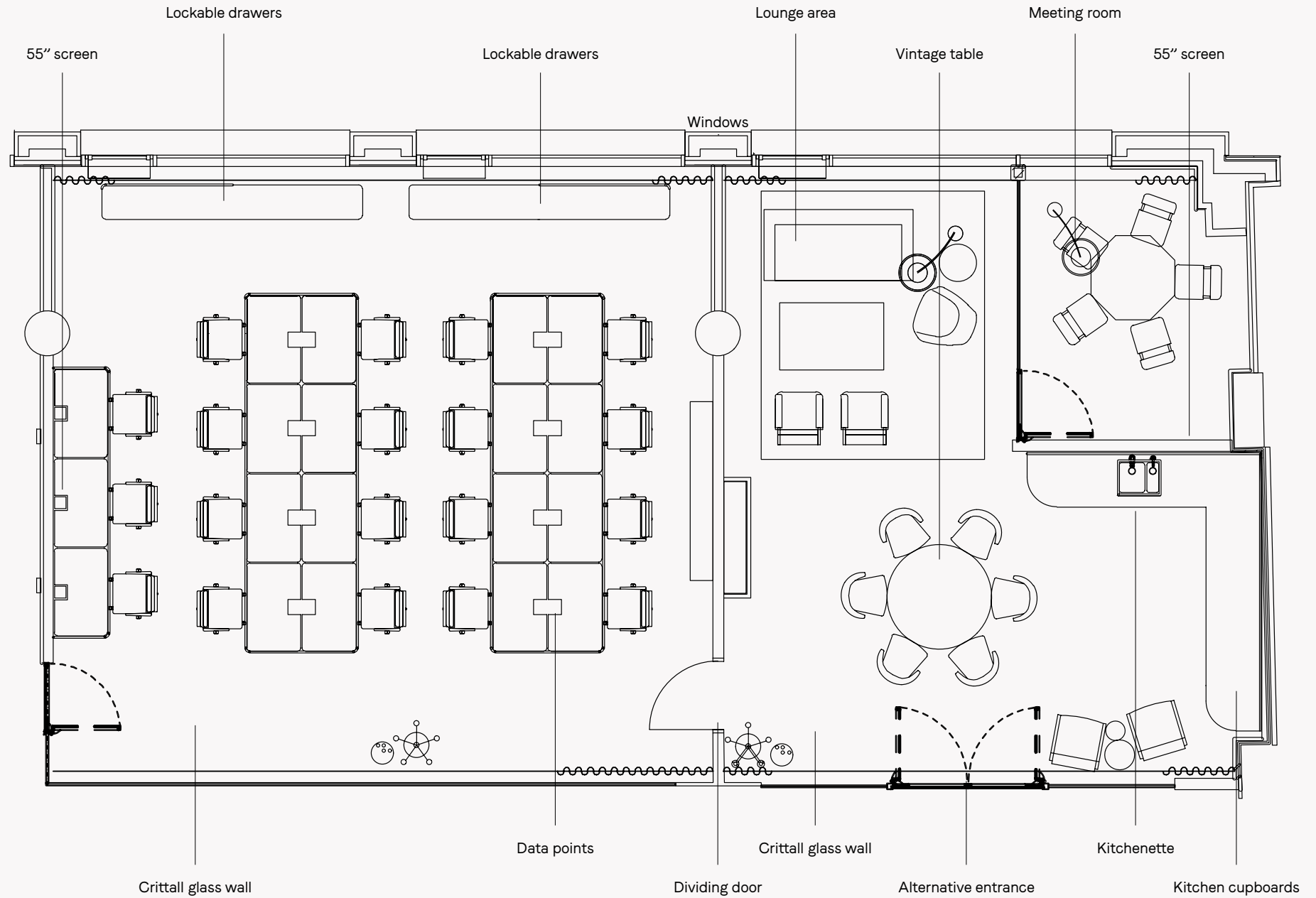

OFFICE THREE

- Lots of natural light
- Overlooking Wood Crescent
- Two entrances
- Additional lounge area
- Private meeting room
- Kitchenette with storage
- Lockable storage drawers
- Large screens with sharing capabilities
- Custom-built wooden desks
- Humanscale ergonomic chairs

Seats 19
1,465 sq ft

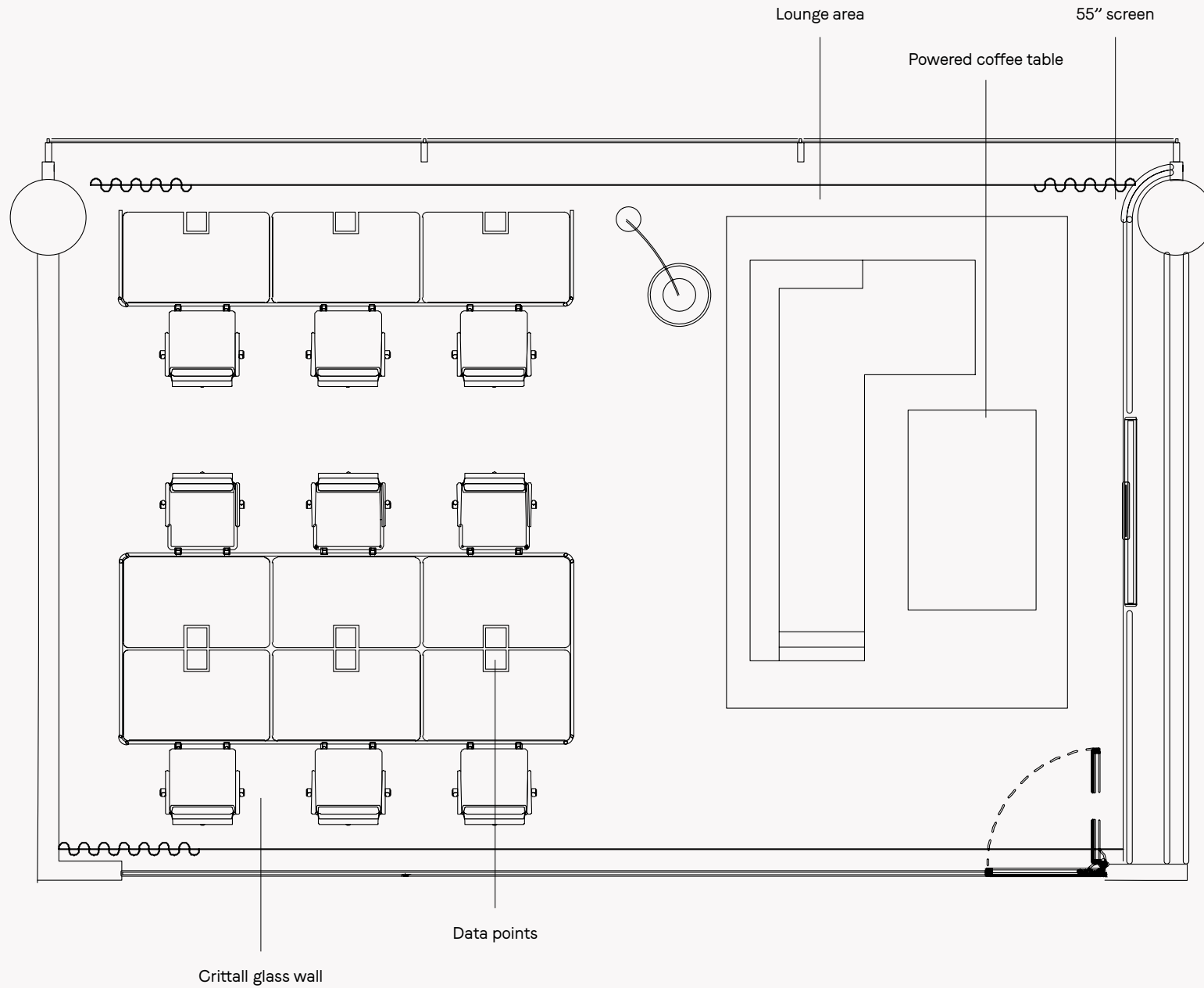

OFFICE FOUR

Natural light
 Overlooking the courtyard
 Additional lounge area
 Large screen with sharing capabilities
 Custom-built wooden desks
 Humanscale ergonomic chairs

Seats 9
 562 sq ft

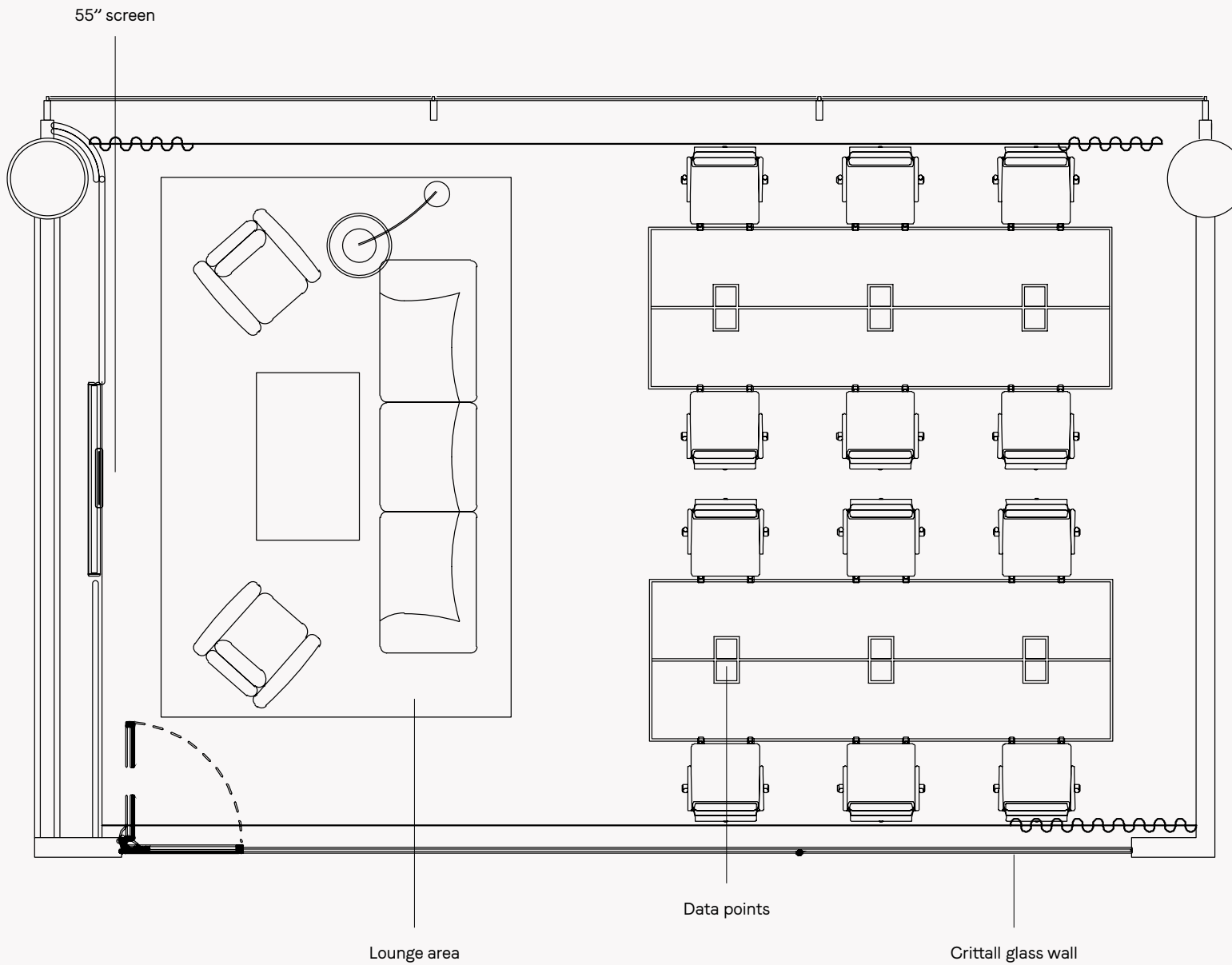

OFFICE FIVE

- Natural light
- Overlooking the courtyard
- Additional lounge area
- Large screen with sharing capabilities
- Custom-built wooden desks
- Humanscale ergonomic chairs

Seats 12
562 sq ft

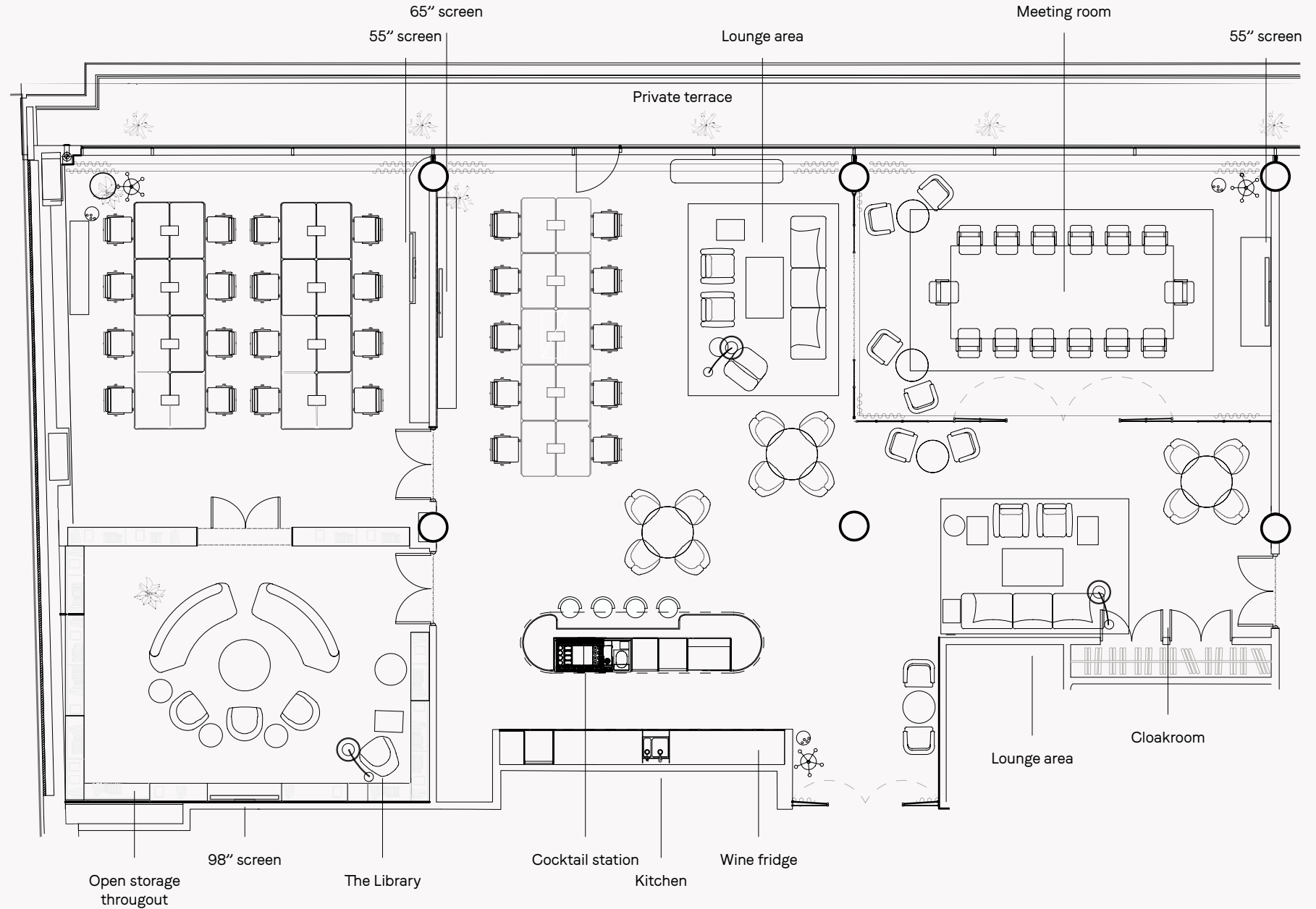

THE LOFT

A collection of rooms that centre around an open-plan kitchen and lounge area.

- Private kitchen with cocktail station
- Private terrace
- Cloakroom
- Lots of natural light
- Variety of seating
- Views over Westfield and TVC courtyard
- Large screens, with video conferencing
- Custom-built wooden desks
- Humanscale ergonomic chairs

Seats up to 40
3,700 sq ft

