

OFFICE MEMBERSHIP

SOHO WORKS

180 STRAND



About Soho Works

Soho Works is an international network of workspaces by Soho House, designed and equipped to help creative thinkers and businesses connect, collaborate, and grow.

Our spaces combine the 'home away from home' feeling of our Houses with all the tools, technology and equipment to help you do your best work.

Each workspace offers meeting rooms, flexible private hire options and a curated programme of member events to help you and your business grow.

Open now in **180 Strand, Dean Street, White City** and **Shoreditch**

Prices are available upon request.



180 Strand



Soho Works is based inside 180 Strand - a Brutalist building on London's vStrand, which is also home to The Store X, Dazed Media Group, IGM and The Vinyl Factory. Our 20,000 sq ft workspace is set across two floors and has a private loft space, meeting rooms, podcast recording studio, phone booths, and a fully equipped kitchen.

180 Strand, London, WC2R 1EA

To find out more about 180 Strand Soho Works, click [here](#)



180 Strand



Soho Works office members have lockable private spaces for teams to work and collaborate, with up to 12 meeting room credits per month.

Enjoy all the benefits of a Lounge membership, plus complimentary Soho Friends membership – this gives you access to Soho House bedrooms, Studios and events, as well as benefits at our spas, restaurants and Soho Home. As a 180 office tenant, members can enjoy 180 Health Club, a new curated space showcasing the best specialists in movement, fitness, mindfulness, beauty and grooming. These services sit alongside the latest body therapy technologies exclusively available at the Health Club.

180 Strand, London, WC2R 1EA



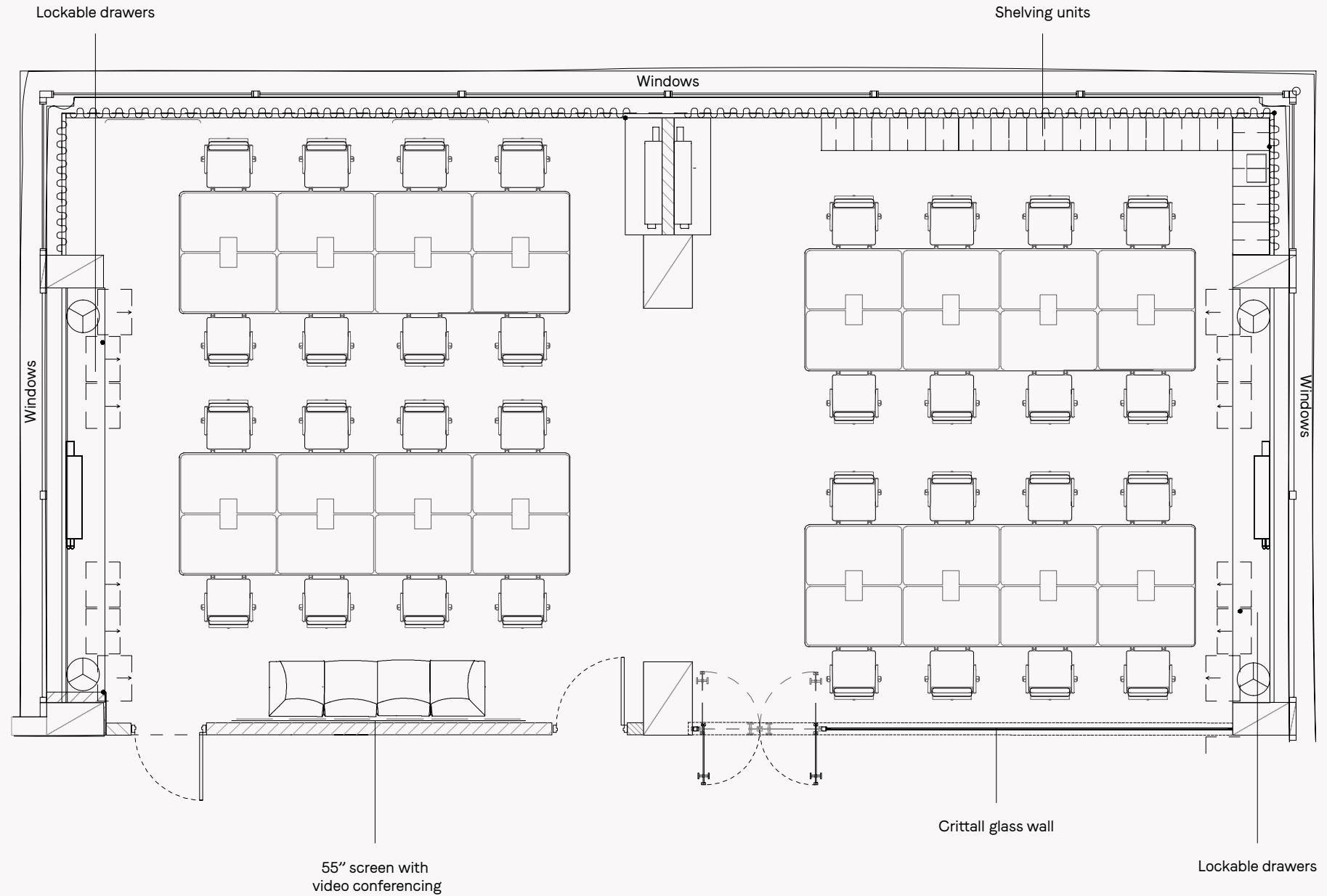

OFFICE ONE

- Open plan layout
- Natural light
- Corner office
- Overlooks The Strand and Surrey St
- Four banks of lockable drawers
- Large screen, with video conferencing
- Bose Videobar
- Ethernet connectivity
- Custom-built wooden desks
- Humanscale ergonomic chairs

Seats 32
1,277 sq ft

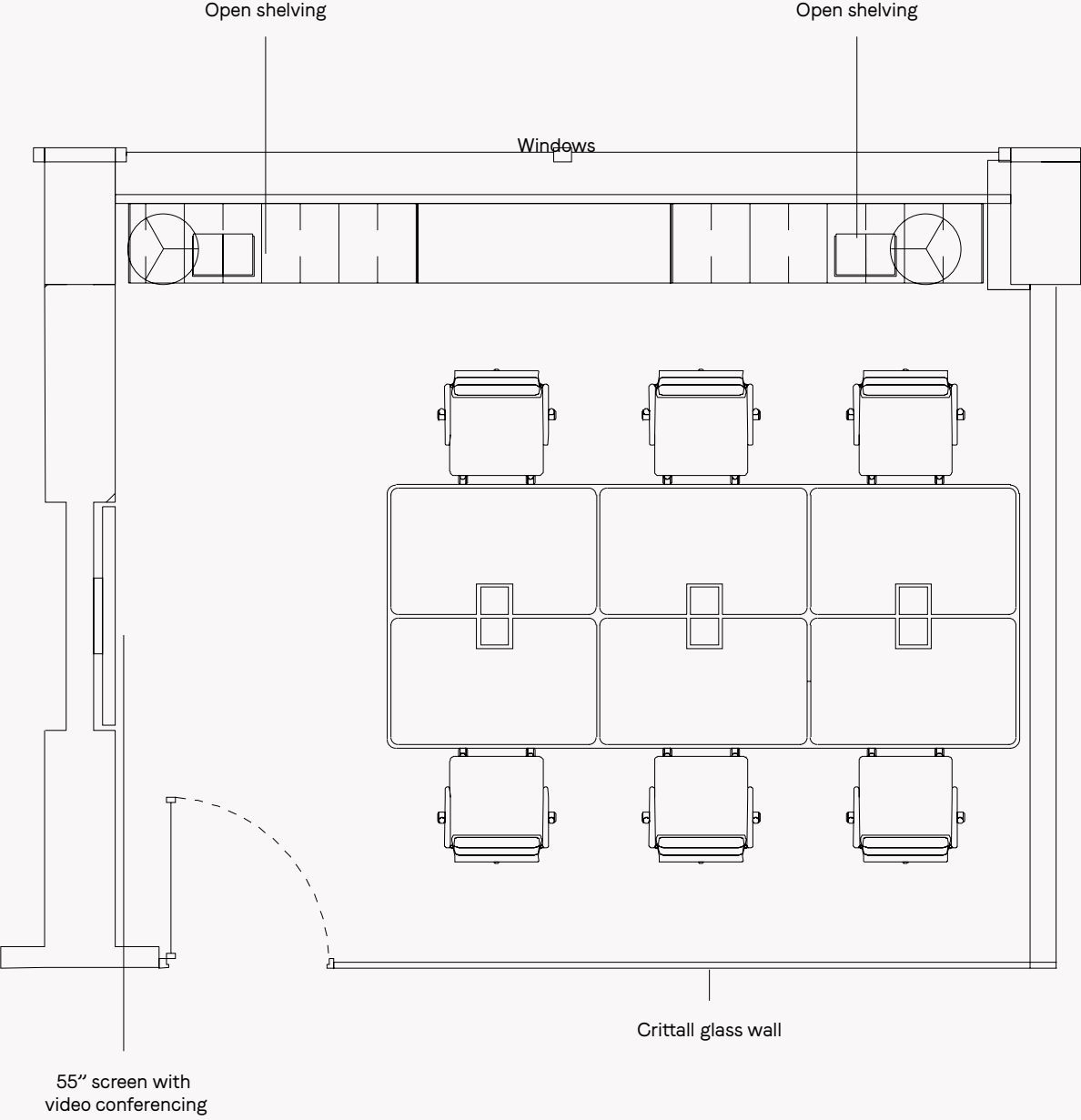

OFFICE TWO

- Natural light
- Overlooks the 180 courtyard
- Plenty of open storage
- Large screen, with video conferencing
- Custom-built wooden desks
- Humanscale ergonomic chairs

Seats 6
272 sq ft

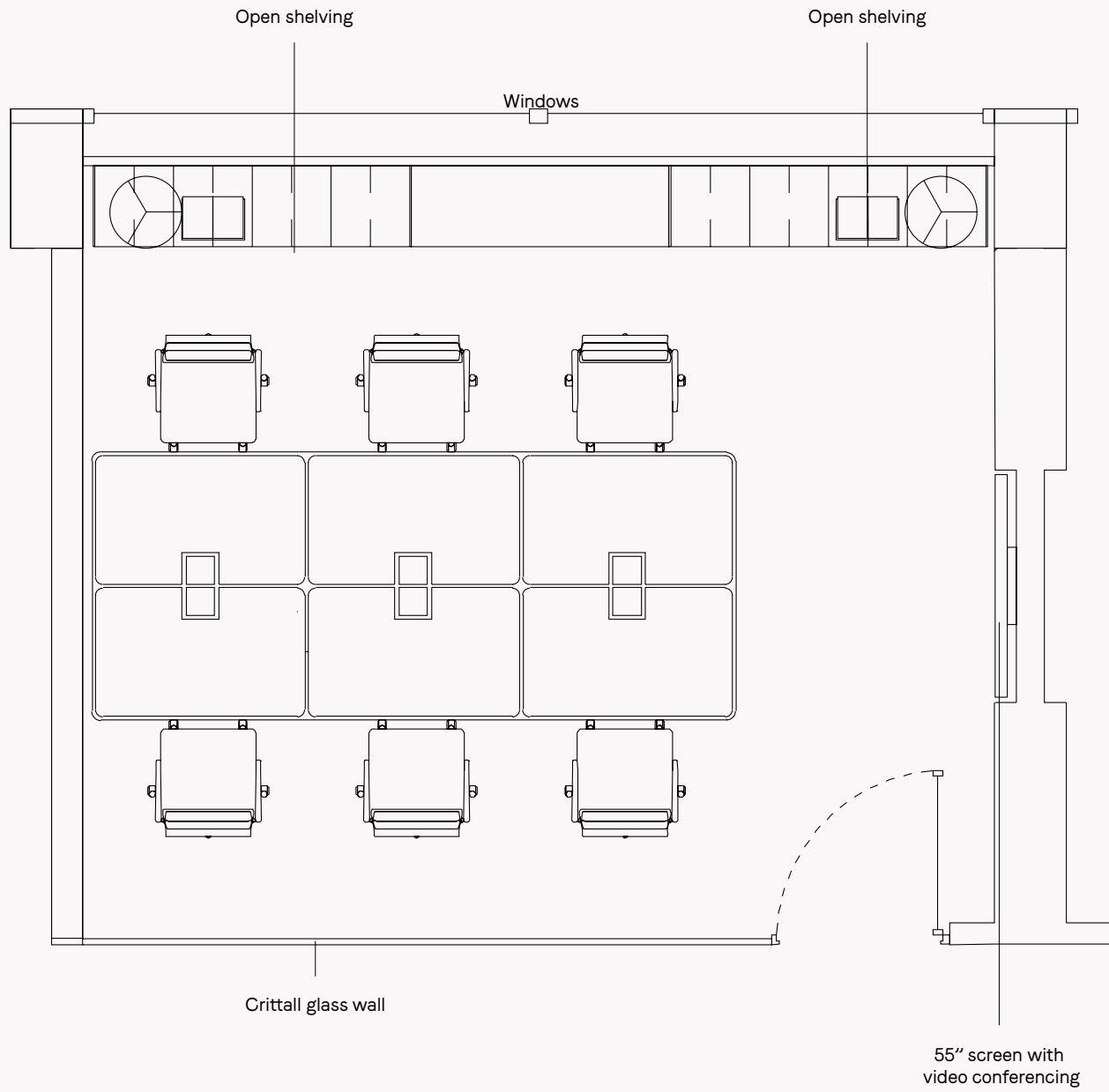

OFFICE THREE

- Natural light
- Overlooks the 180 courtyard
- Plenty of open storage
- Large screen, with video conferencing
- Custom-built wooden desks
- Humanscale ergonomic chairs

Seats 6
272 sq ft

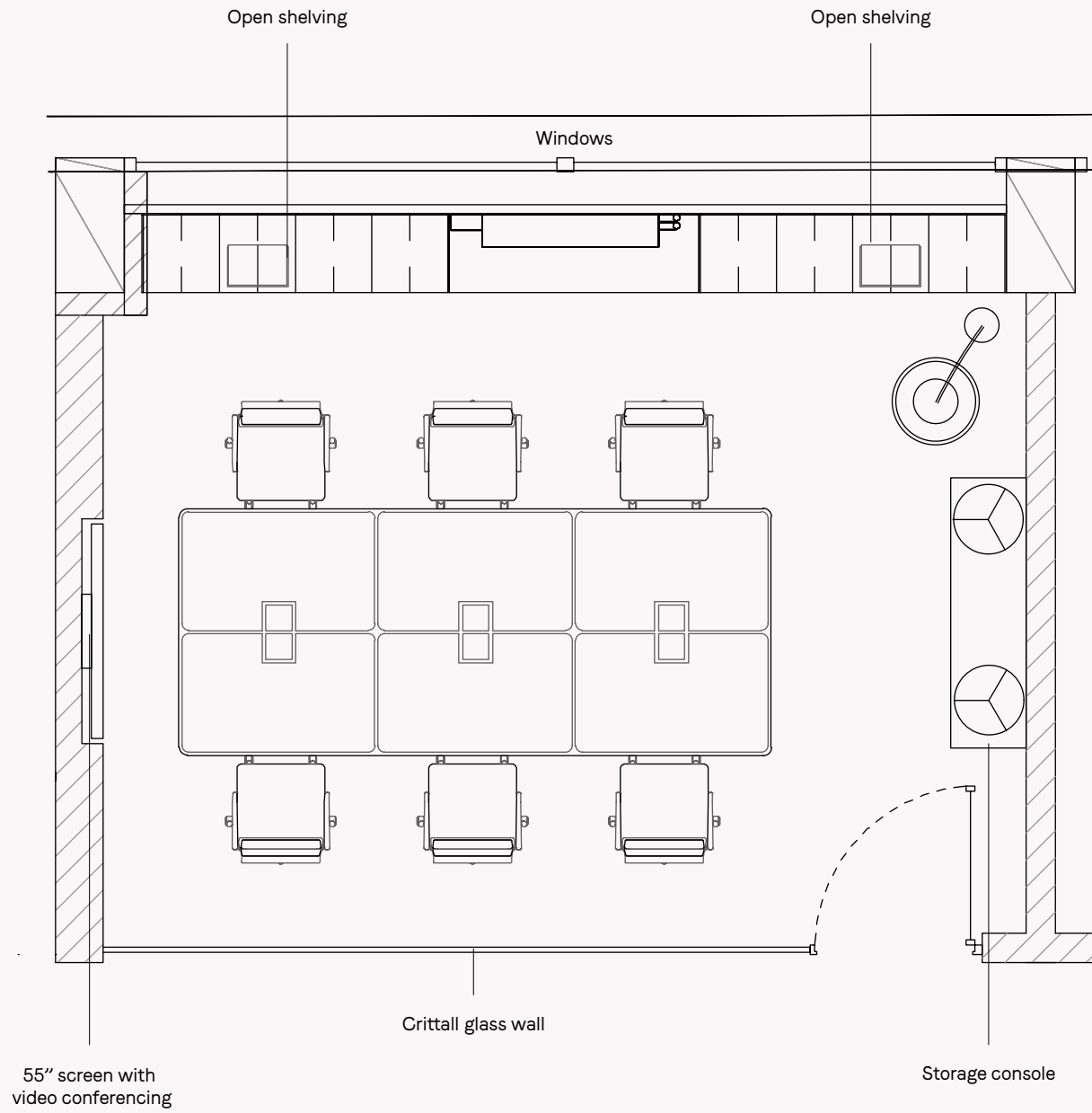

OFFICE FOUR

- Natural light
- Overlooks The Strand
- Lots of storage
- Large screen, with video conferencing
- Custom-built wooden desks
- Humanscale ergonomic chairs

Seats 6
272 sq ft

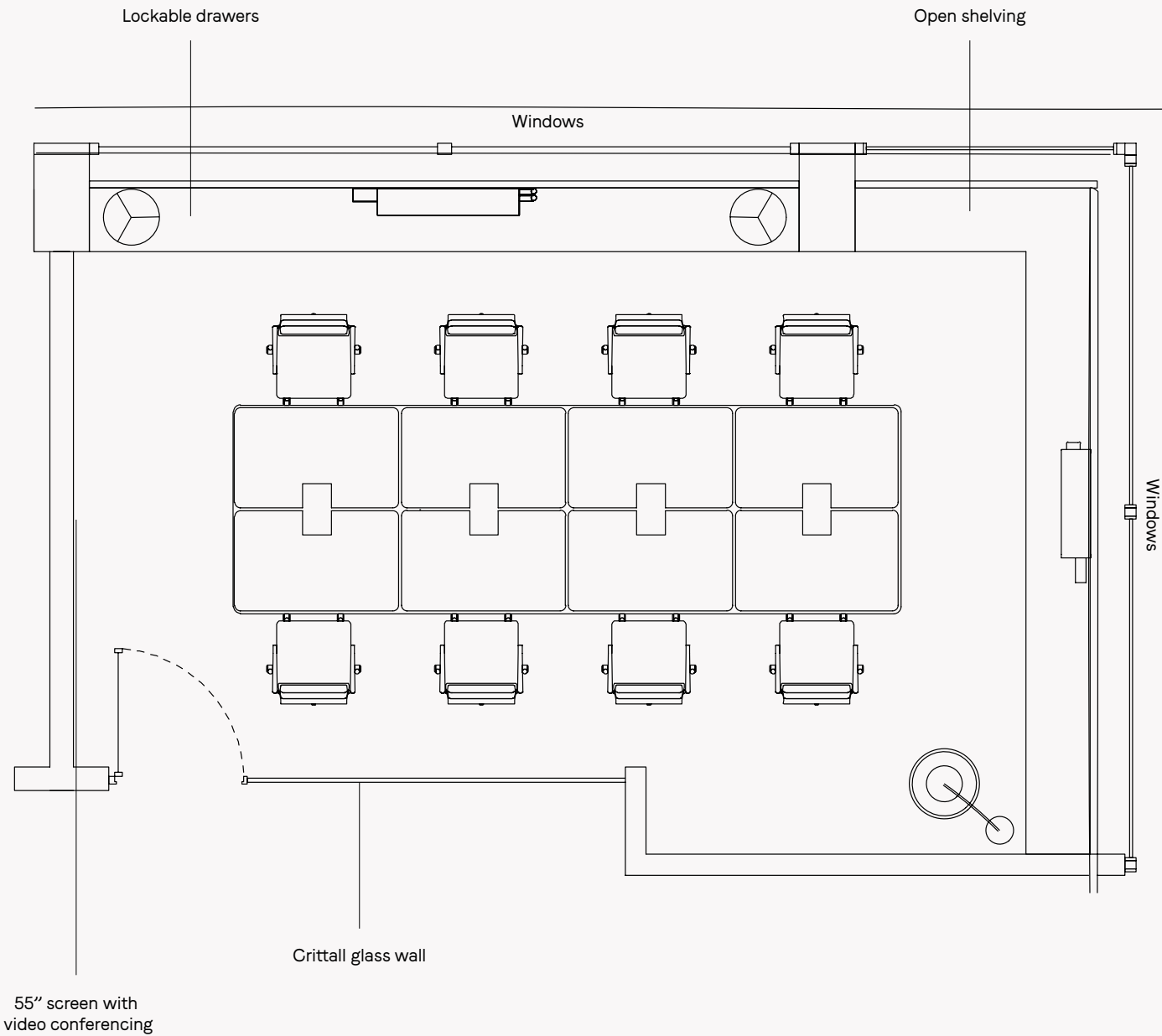

OFFICE FIVE

- Natural light
- Corner office
- Overlooks The Strand and Arundel St
- Plenty of storage
- Large screen, with video conferencing
- Bose Videobar
- Custom-built wooden desks
- Humanscale ergonomic chairs

Seats 8
391 sq ft

